

Thermostat Set

Schell Nano Thermostat Tempering Valve
Underbench

Code:
S0940606

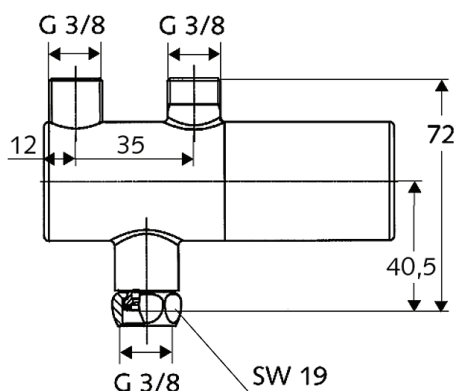

- Thermostat control valve for installation on angle valves with 3/8 ext. thread outlet.
- Max. draw-off temperature adjustment concealed by cover, only possible with tools.
- Thermostat of extending material in accordance with EN 1111 in brass-housing conform German drinking water regulation, chrome-plated plastic cover.
- SCHELL angle valve thermostat
- Filter inserts and backflow preventer (BP, DIN EN 1717: EB)
- Max. draw-off temperature limitation 5 - 40 °C
- Anti-scalding protection in case of interrupted cold water supply
- Thermostatic anti-scalding fitting for adjustment of flow temperature for mounting on angle valves with G 3/8 external thread, flow class A, EN 1111
- Possibility of thermal disinfection, readjustment of temperature not required
- Flow volume 13 l/min at 3 bar
- Test Mark: DIN-DVGW certified
- Surface: chrome
- Weight: 0.7 kg/pc.
- Packaging unit: 1
- RECOMMENDED ASSOCIATED ITEM:
 - For wash basin taps PURIS, VENUS, CELIS, MODUS, XERIS and PETIT
 - Pipe set for angle valve thermostat 04 109 06 99 or connection set for angle valve thermostat 04 114 06 99



DESIGNED AND MANUFACTURED IN GERMANY

